

Kraft- und Energie-Weg-Diagramme

Form-Nr. 25444

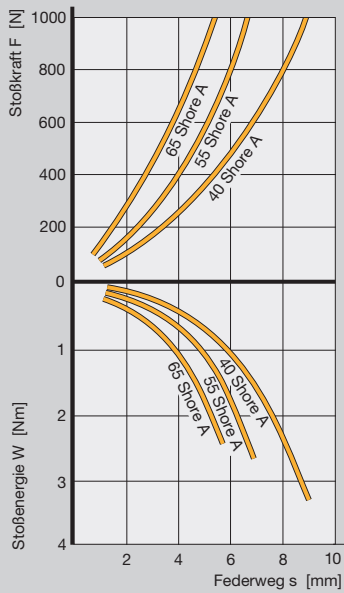

Form-Nr. 25481

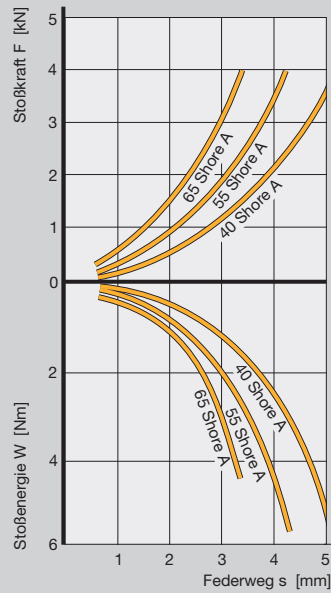

Form-Nr. 25443

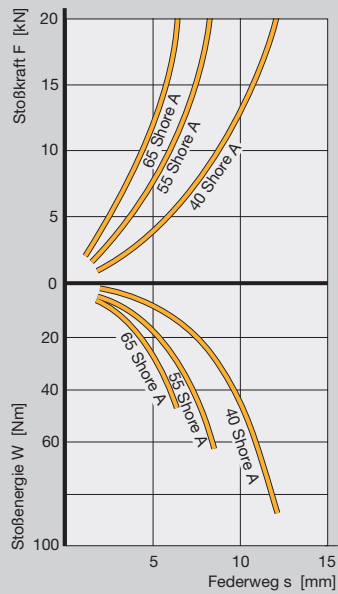

Form-Nr. 38655

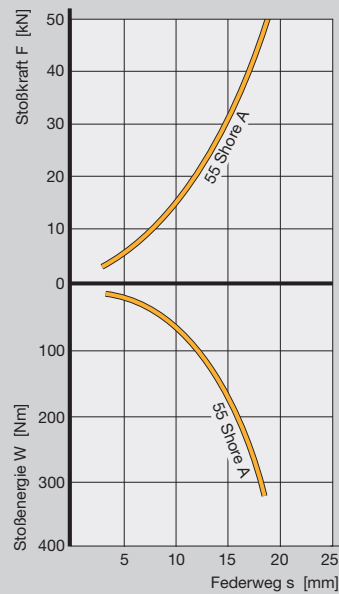

SCHWINGMETALL® Anschlagsschienen

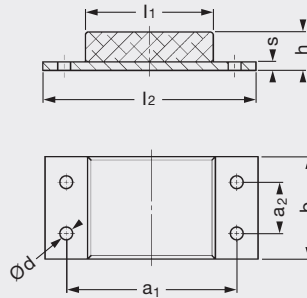
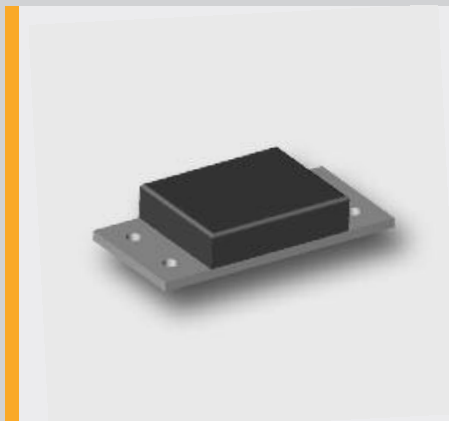

Anschlagsschienen													
Abmessungen								max. Belastungen		Masse Stück [kg]	Elastomer Härte [Shore A]	Form-Nr.	Artikel-Nr.
a1 [mm]	a2 [mm]	b [mm]	d [mm]	h [mm]	l1 [mm]	l2 [mm]	s [mm]	F _Z [N]	W [N/mm]				
100	1) ¹⁾	50	2 x 8.5	35	70	130	5	10100	40	0,360	55	25081b/AN	3973501000
100	1) ¹⁾	50	2 x 8.5	70	70	130	5	9614	89	0,500	55	25080/AN	3973502000
160	50	100	4 x 13	45	120	200	10	36256	175	1,935	55	20299/AN	3974505000
160	50	100	4 x 13	80	120	200	10	35758	420	2,430	55	24472/AN	3974506000
200	60	120	4 x 15	45	150	250	10	58491	250	2,900	55	21422b/AN	3974507000
200	60	120	4 x 15	70	150	250	10	58654	497	3,470	55	21422/AN	3974508000
250	80	150	4 x 17	50	200	300	15	97971	330	6,150	55	21055b/AN	3975509000
250	80	150	4 x 17	80	200	300	15	99552	950	7,250	55	21055/AN	3975510000

1) a2 ohne Maßangabe entspricht mittiger Bohrung.

Belastungsrichtung

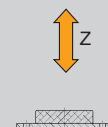

Kraft- und Energie-Weg-Diagramme



Form-Nr. 25081b/AN

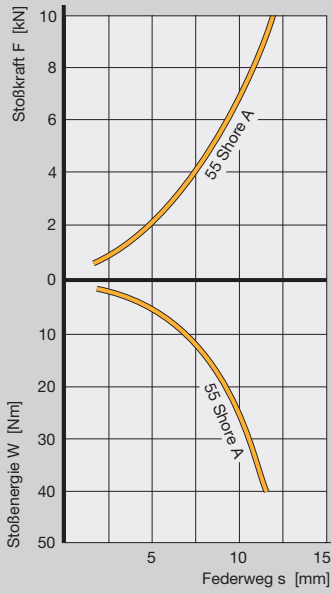

Form-Nr. 25080/AN

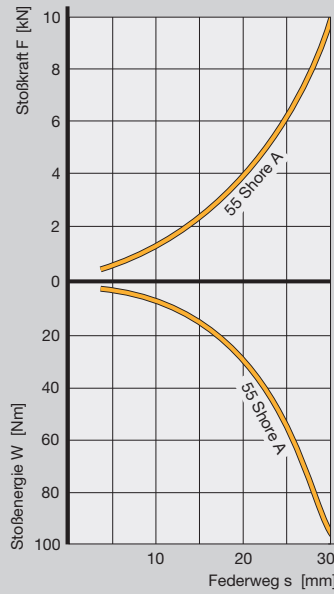

Form-Nr. 20299/AN

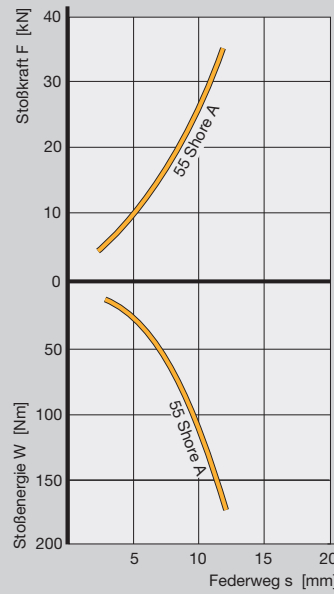

Form-Nr. 24472/AN

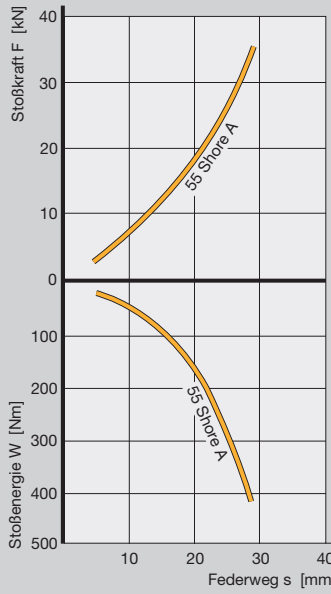

Form-Nr. 21422b/AN

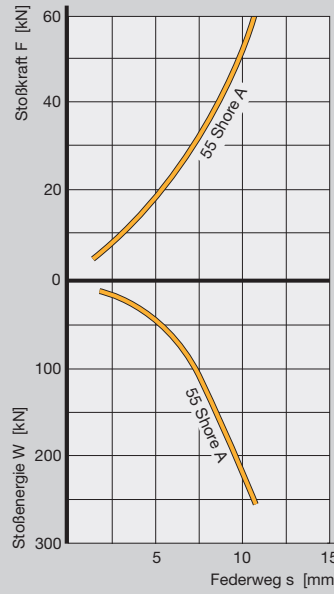

Form-Nr. 21422/AN

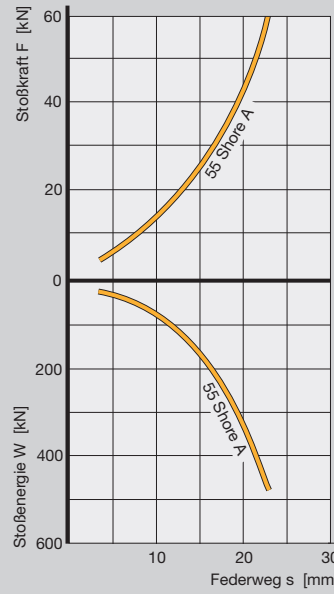

Form-Nr. 21055b/AN

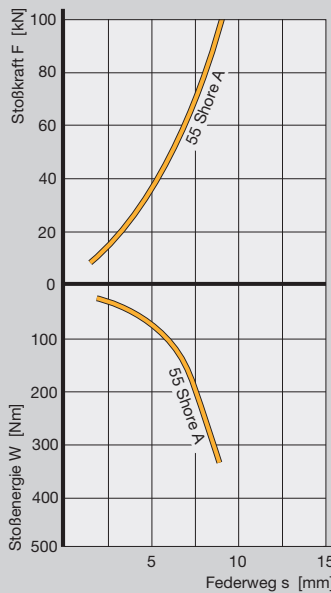

Form-Nr. 21055/AN

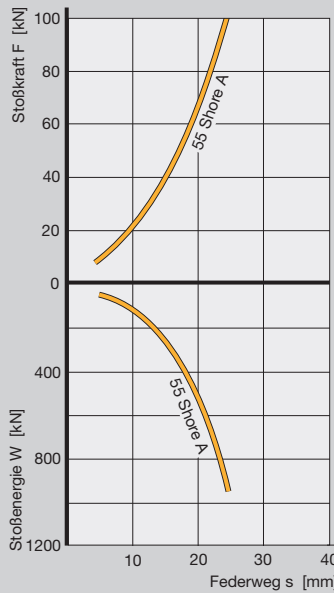

Anschläge